

OVERRUN DEVICE

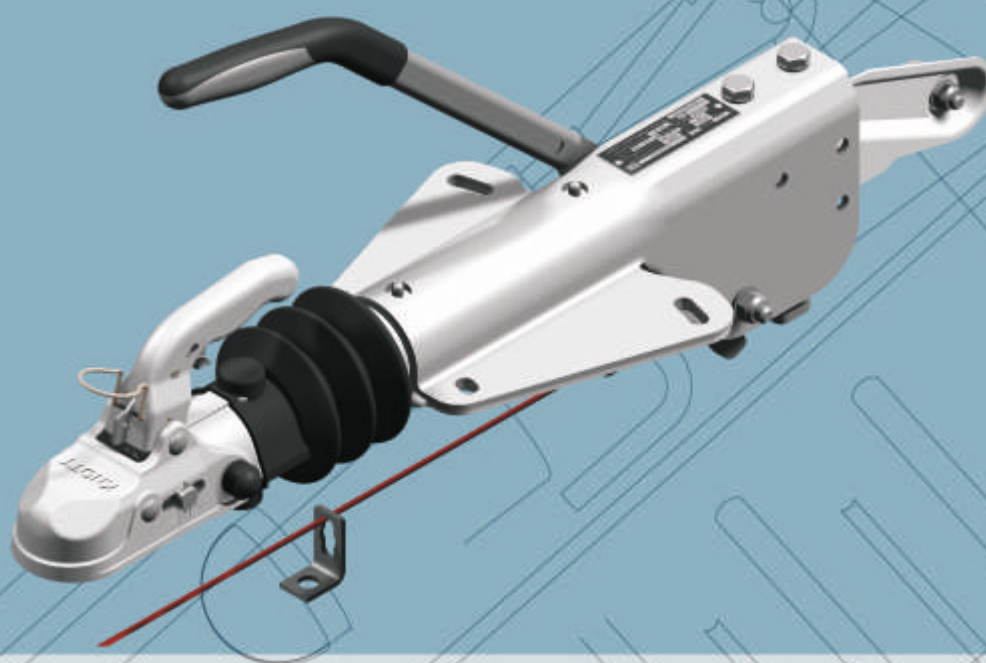

OVERRUN DEVICES

Coupling device type: Mechanical

Surface treatment: Hot dip galvanization

Salt spray test: 500 h

Can be used for:

- V chassis
- Tube
- Square tube

Additional parts:

- plug holder
- bracket for jockey wheel
- safety cable
- handle.

Advantages:

- easy to mount
- safe to use
- has lightweight construction
- compact and easy to assemble

Overrun devices with hand brake

Mechanic

Hydraulic



Working system:

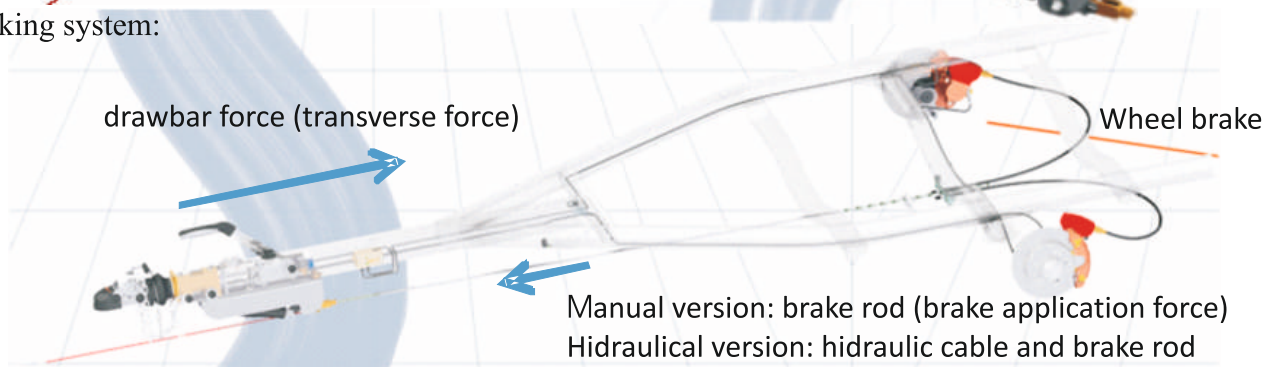

Overrun type: Hydraulic

Advantages:

- easy to mount
- safe
- lightweight construction
- compact and easy to assemble

Surface treatment: Galvanization

Salt spray test: 500 h

Additional:

- plug holder
- bracket for jockey wheel
- safety cable console
- handle

Use for:

- V chassis
- Square tube

**A hydraulic overrun device equipped with a handbrake is currently under construction.
Planned completion: end of 2013.**

SPARE PARTS OF OVERRUN COUPLING KF 7,5-20 GF

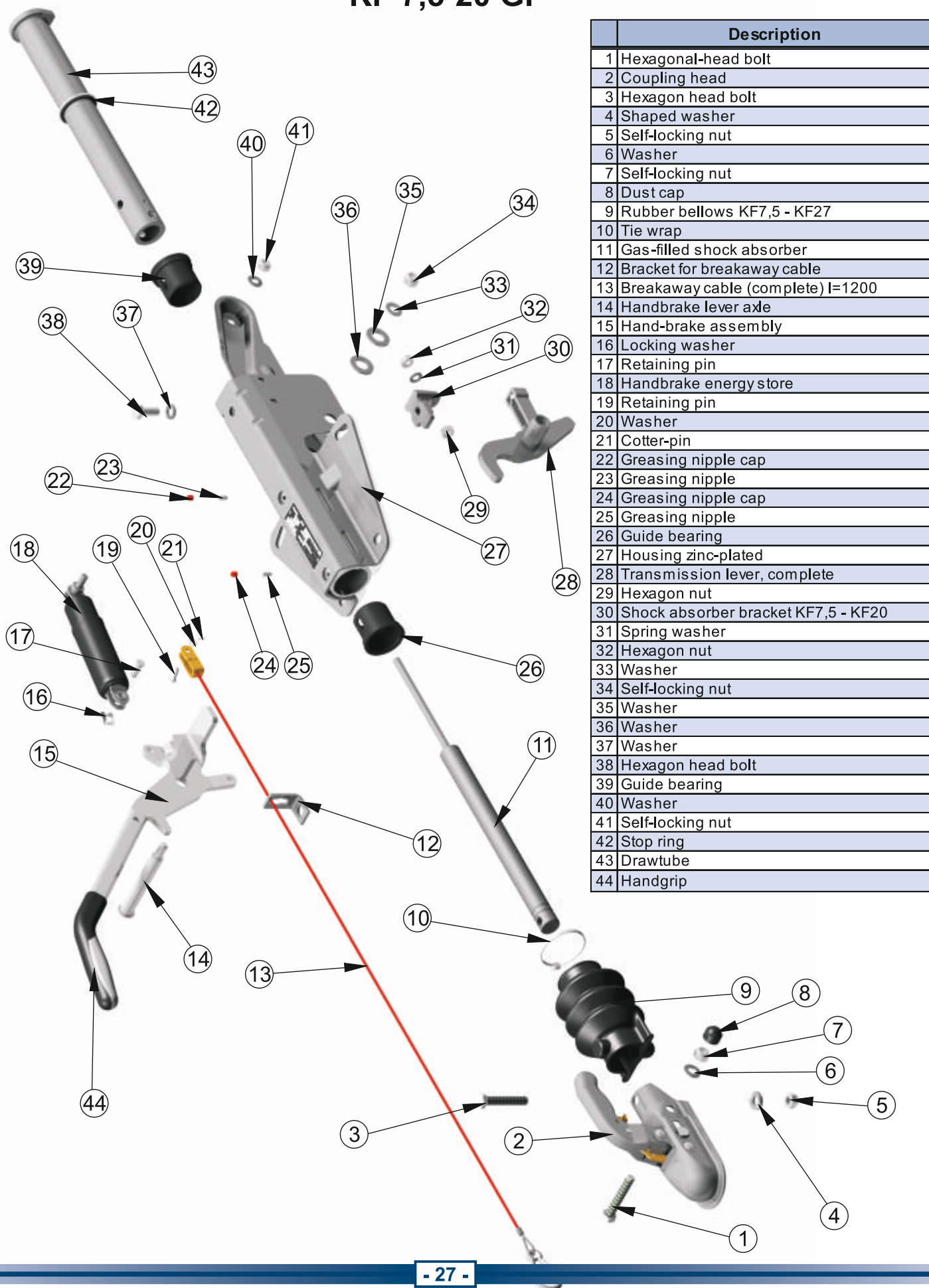

OVERRUN A FRAME COUPLING KF 7,5 - 30

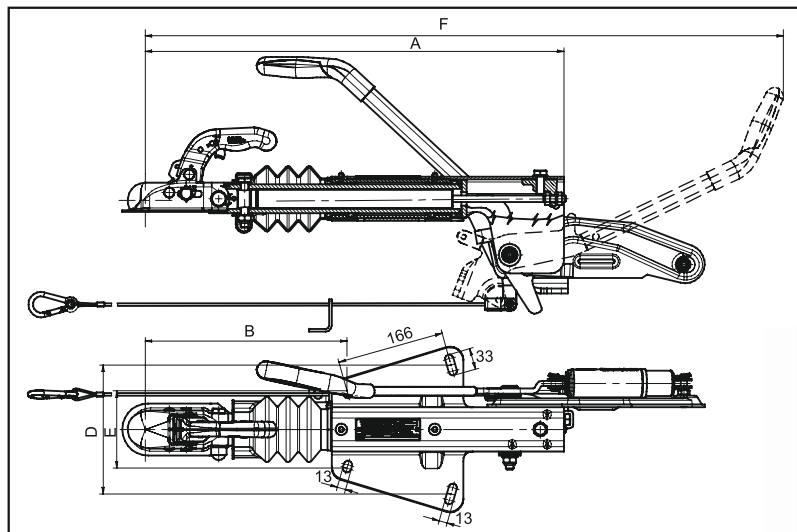

KF 7,5-20

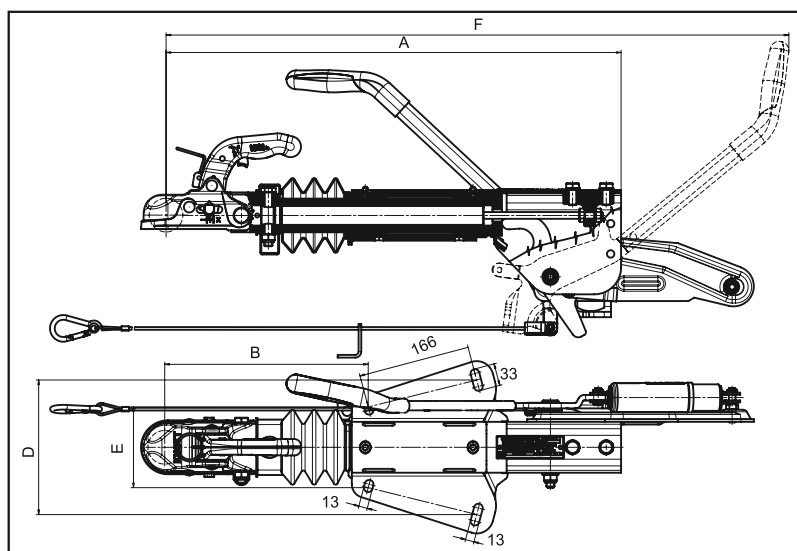

KF 27-30



Type	Coupling head	Vertical load (max. kg)	GVWR (kg)	A (mm)	B (mm)	D (mm)	E (mm)	F (mm)	EC-number	ECE number	Article number
KF 7,5 C	KK14BN3	100	750	649	313	200	110	990	00-0728	55R-012073	6J1356.102
KF 13 C	KK14BN3	100	1300	649	313	200	110	990	00-0728	55R-012073	6J1060.102
KF 20 A	K20BN3	100	2000	649	313	200	110	990	00-0728	55R-012073	6J1191.107
KF 27 A1	K27AN3	150	2700	676	302	200	110/120	925	00-0757	55R-012063	6J2200.004
KF 30 C	K35AN3	150	3000	682	313	200	110/120	946	00-1282	55R-012066	205244.001

The overrunning can be ordered either with DIN or with NATO eye

OVERRUN A FRAME COUPLING KFL 12 - 14

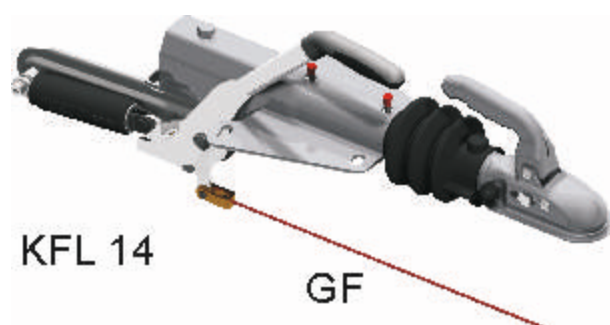
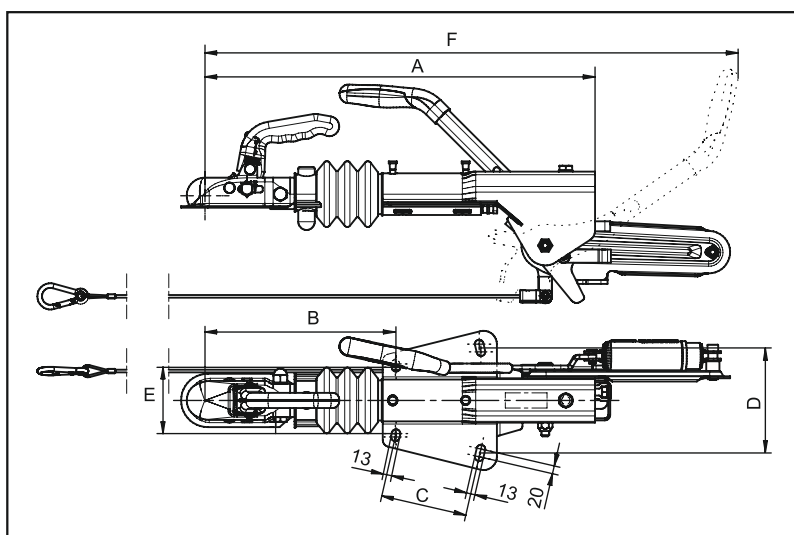
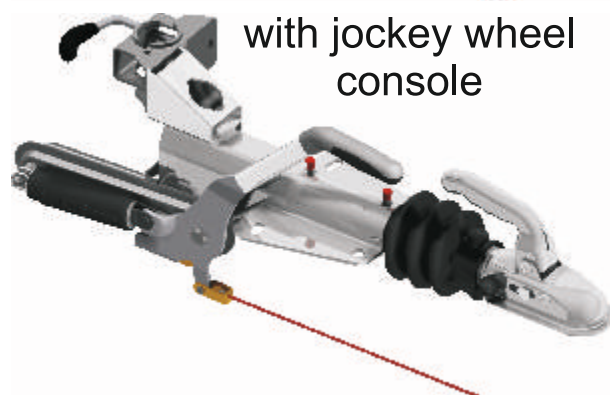
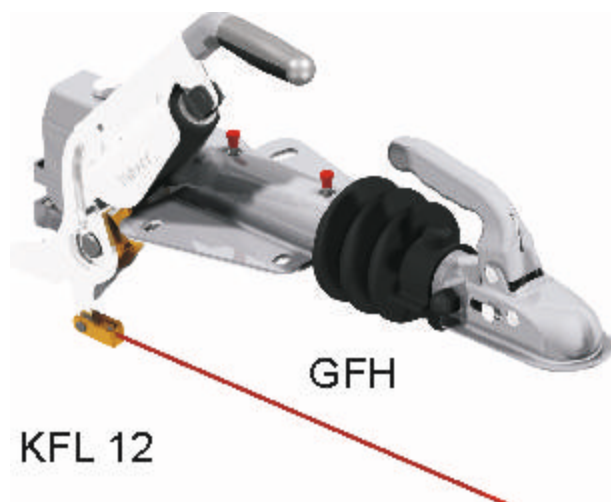
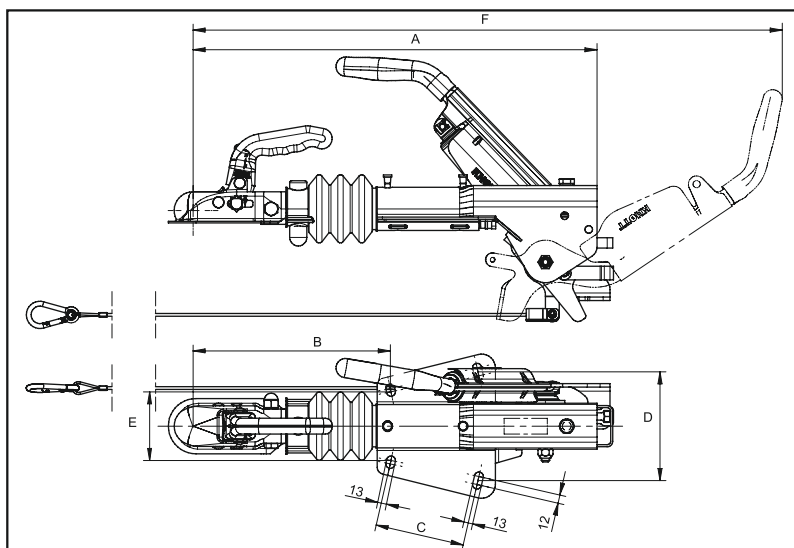

Type	Model	Coupling head	Vertical load (max. kg)	GVWR (kg)	A (mm)	B (mm)	C (mm)	D (mm)	E (mm)	F (mm)	EC-number	ECE number	Article number
KFL 12 A	GFH	KK14BN3	100	1300	588	288	130	158	100/110	858	00-1590	55R-011590	203742.001
KFL 12 B	GF	KK14BN3	100	1400	588	288	130	170	100/110	804	00-1590	55R-011590	204005.001
KFL 12 A	GF	KK14BN3	100	1300	588	288	130	170	100/110	804	00-1590	55R-011590	204786.001
KFL 14 A	GF	KK14BN3	100	1400	589	288	166	200	100/120	805	00-1590	55R-011590	205521.001
KFL 14 A	GFH	KK14BN3	100	1400	588	288	166	200	100/120	858	00-1590	55R-011590	205523.001

The overrunning can be ordered either with DIN or with NATO eye

Weight range 1100 - 2700 kg

NEW!



Highlights

- Compact, attractive design
- Light and stable construction
- Central supporting point
- Hole pattern is same as the previous version KF20 (110-120 / 166)
- Fitting bolted-on console is available
- Requires minimal maintenance
- Holder for spring energy store integrated into the reinforcement plate

KFL 20, KFL 27

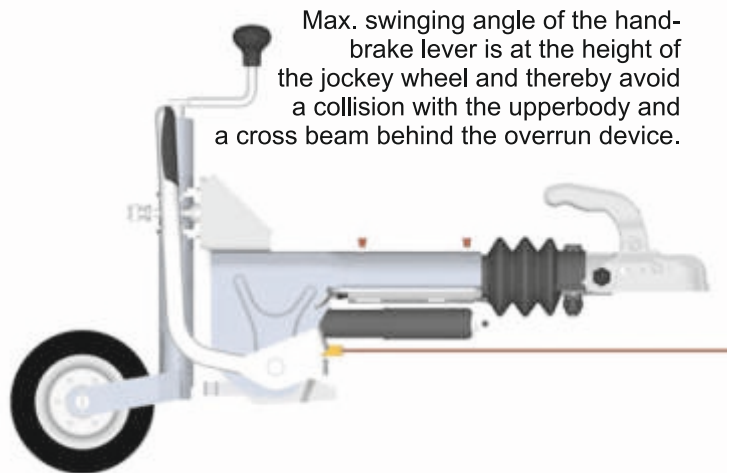

OVERRUN A FRAME COUPLING KFL 20 - 27 GFV

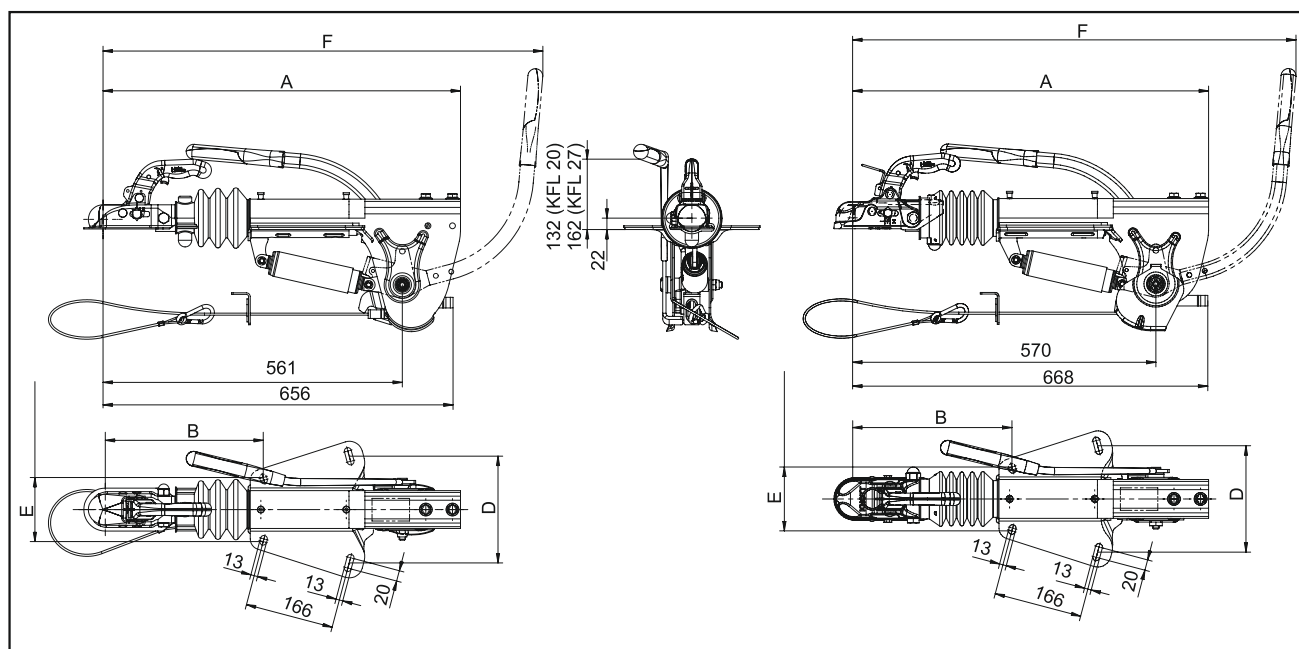
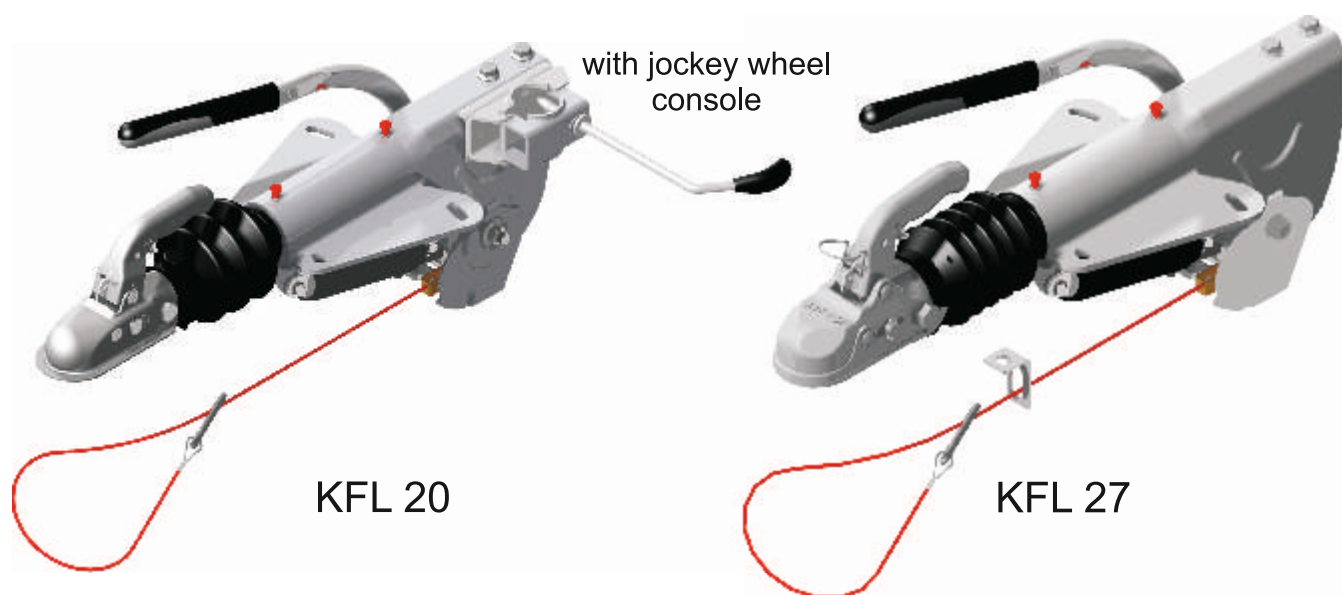

Type	Coupling head	Vertical load (max. kg)	GVWR (kg)	A (mm)	B (mm)	D (mm)	E (mm)	F (mm)	EC-number	ECE number	Article number
KFL 20 A	K24N3	100	2000	670	296	200	110/120	764	---	55R-011950	205179.001
KFL 20 B	K24N3	100	2400	670	296	200	110/120	824	---	55R-011950	206174.001
KFL 27 A	K27AN3	150	2700	669	299	200	110/120	833	---	55R-012116	206606.001

The overrunning can be ordered either with DIN or with NATO eye

OVERRUN A FRAME COUPLING KFG 30-35 GF

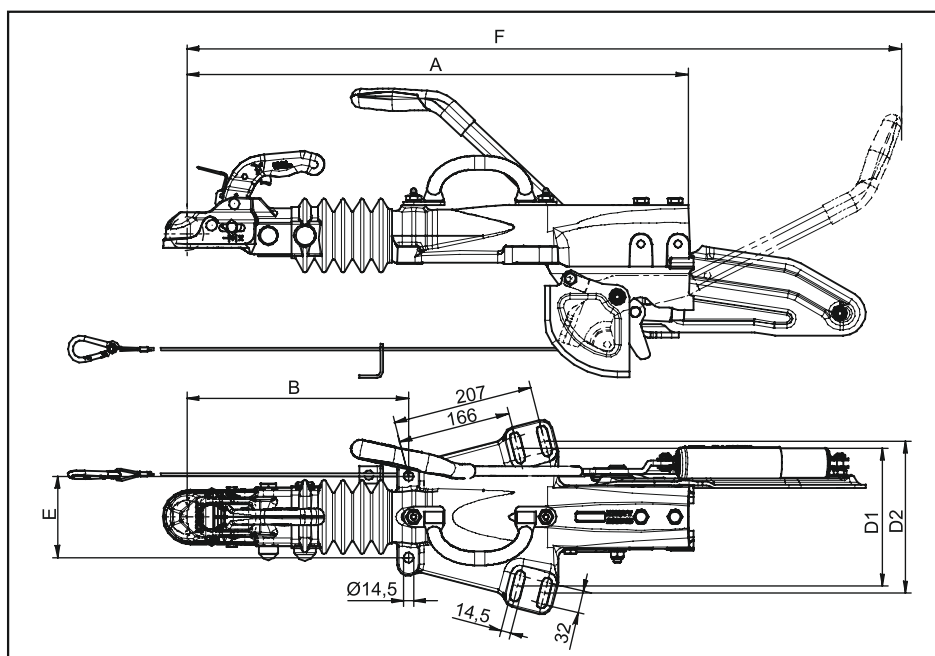
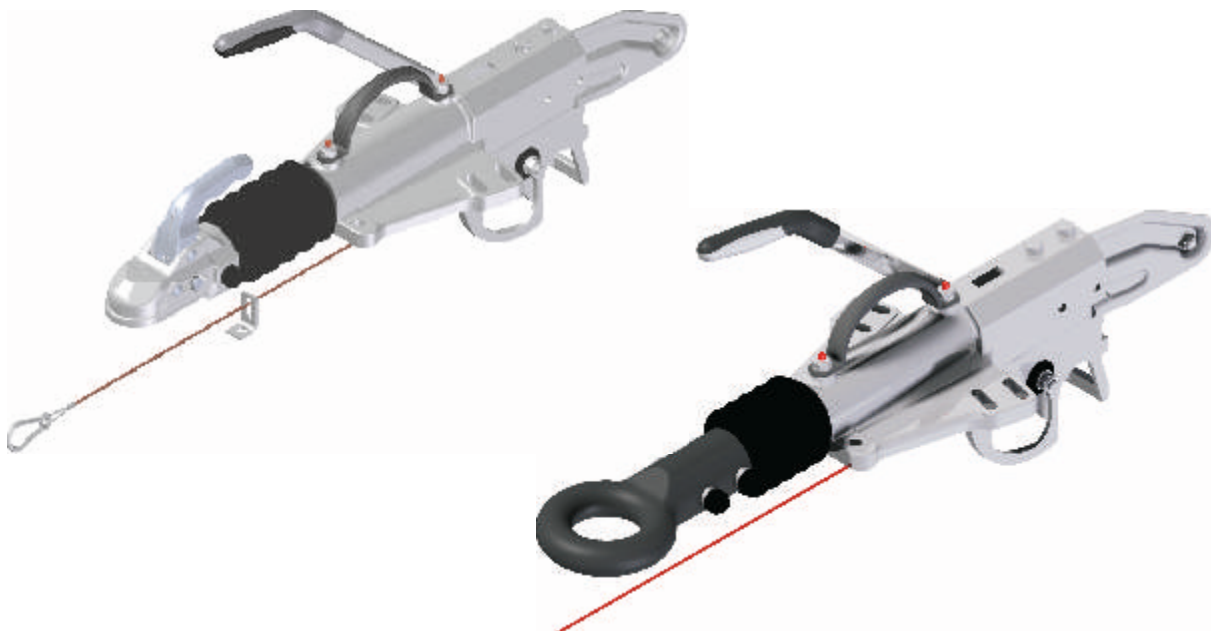

Type	Coupling head	Vertical load EC (max. kg) ECE	GVWR (kg)	A (mm)	B (mm)	D1 (mm)	D2 (mm)	E (mm)	F (mm)	EC-number	ECE number	Article number
KFG 30 A	K35AN3	150 300	3000	673	300	181	239	120	988	00-0646	55R-010646	6J1493.004
KFG 35 D	K35CN3	150 350	3500	738	326	203	220	140	1052	00-0647	55R-010647	6J1599.402
KFG 35 D	DIN eye	150 350	3500	738	326	203	220	140	1052	00-0647	55R-010647	6J1599.404
KFG 35 D	NATO eye	150 350	3500	738	326	203	220	140	1052	00-0647	55R-010647	6J1599.405

The overrunning can be ordered either with DIN or with NATO eye

OVERRUN A FRAME COUPLING KFGL 35

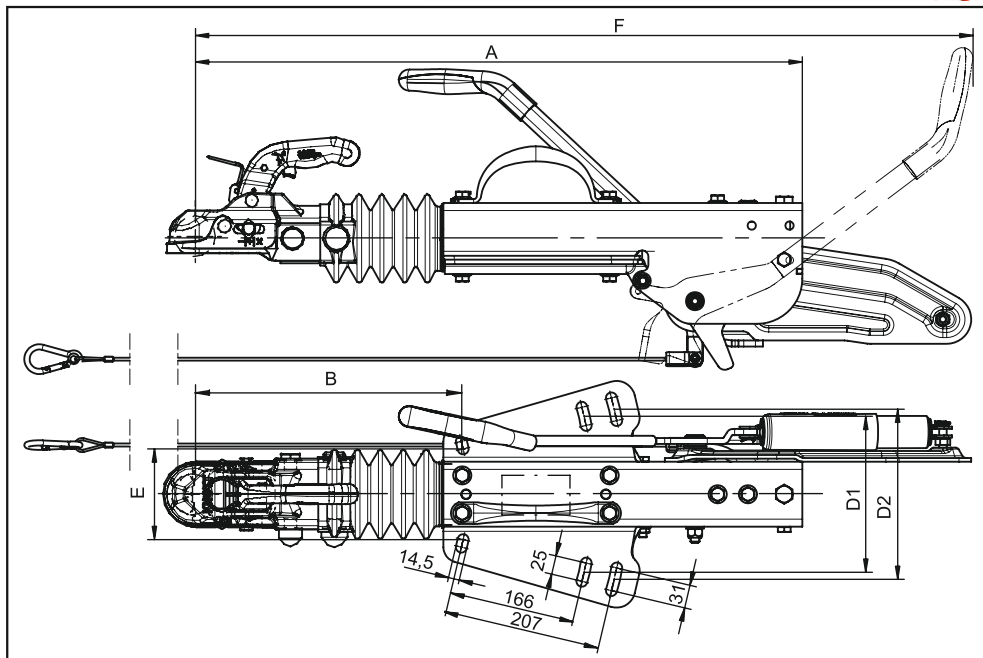
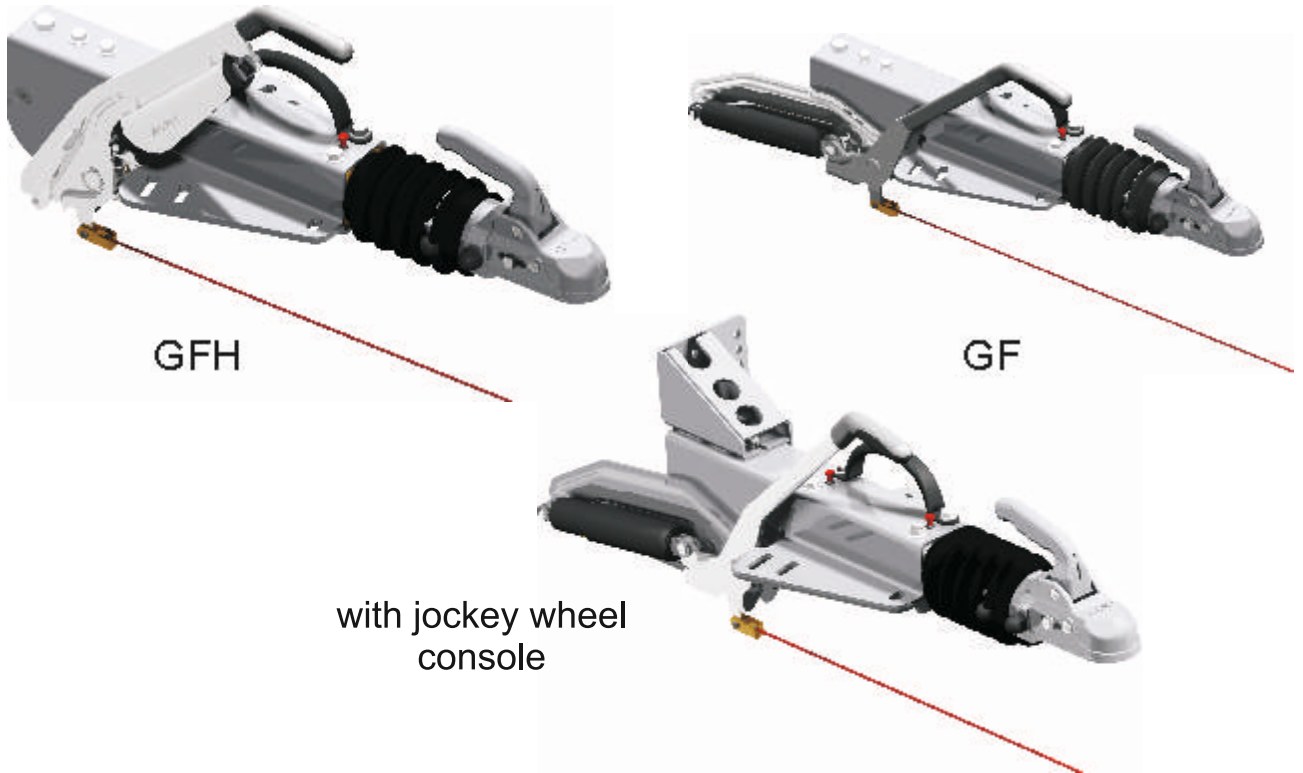

Type	Model	Coupling head	Vertical load (max. kg)	GVWR (kg)	A (mm)	B (mm)	D1 (mm)	D2 (mm)	E (mm)	F (mm)	EC-number	ECE number	Article number
KFGL 35 A	GF	K35CN3	150	3500	774	324	206	225	120/140	1056	00-1730	55R-011730	204530.001
KFGL 35 A	GF	K35CN3	150	3500	774	324	206	225	120/140	1056	00-1730	55R-011730	204532.001
KFGL 35 A	GFH	K35CN3	150	3500	774	324	206	225	120/140	1056	00-1730	55R-011730	204509.001
KFGL 35 A	GFH	K35CN3	150	3500	774	324	206	225	120/140	1056	00-1730	55R-011730	204778.001

The overrunning can be ordered either with DIN or with NATO eye

OVERRUN IN-LINE COUPLING (square tube) KV 13-18

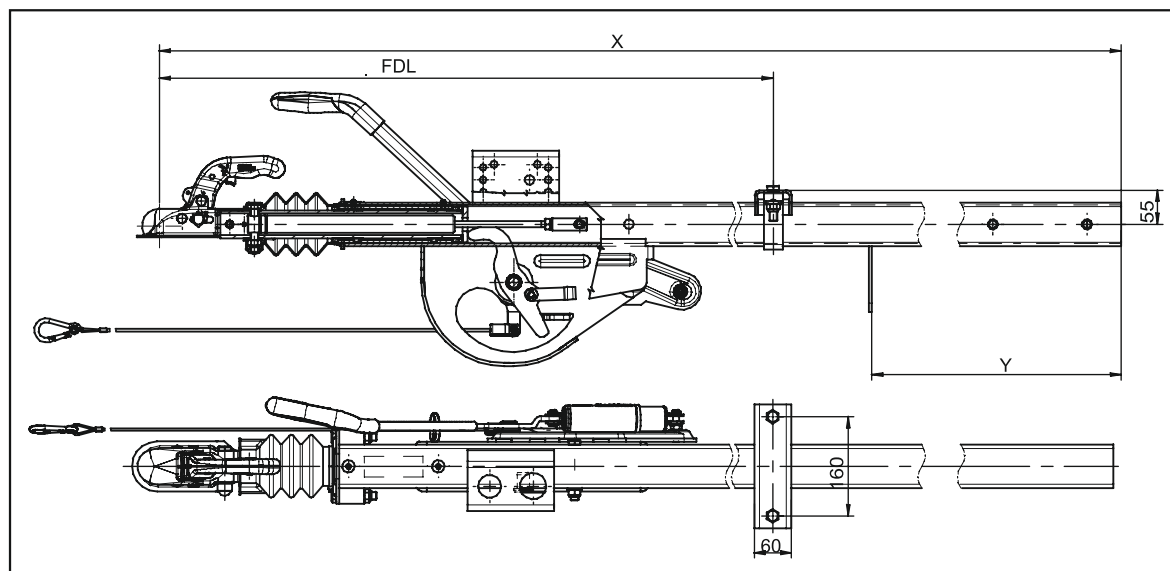

Type	FDL at GA	GVWR (kg)
KV 13 C2	1400 kg/ 1235 mm	1300
KV 18 C	2000 kg/ 1044 mm	2000

Type	Model	Coupling head	Vertical load (max. kg)	X (mm)	Y (mm)	D (mm)	EC-number	Article number
KV 13 C2	GF	KK14BN3	100	2520	1130	70×70×4	00-0766	6J2082.001
KV 18 C	GF	K20BN3	100	2600	1130	70×70×5	00-0553	6J2088.001

Length "X" can be specified according to the requirements
The overrunning can be ordered either with DIN, or with NATO eye.

OVERRUN IN-LINE COUPLING (square tube) KRV 7,5 - 35

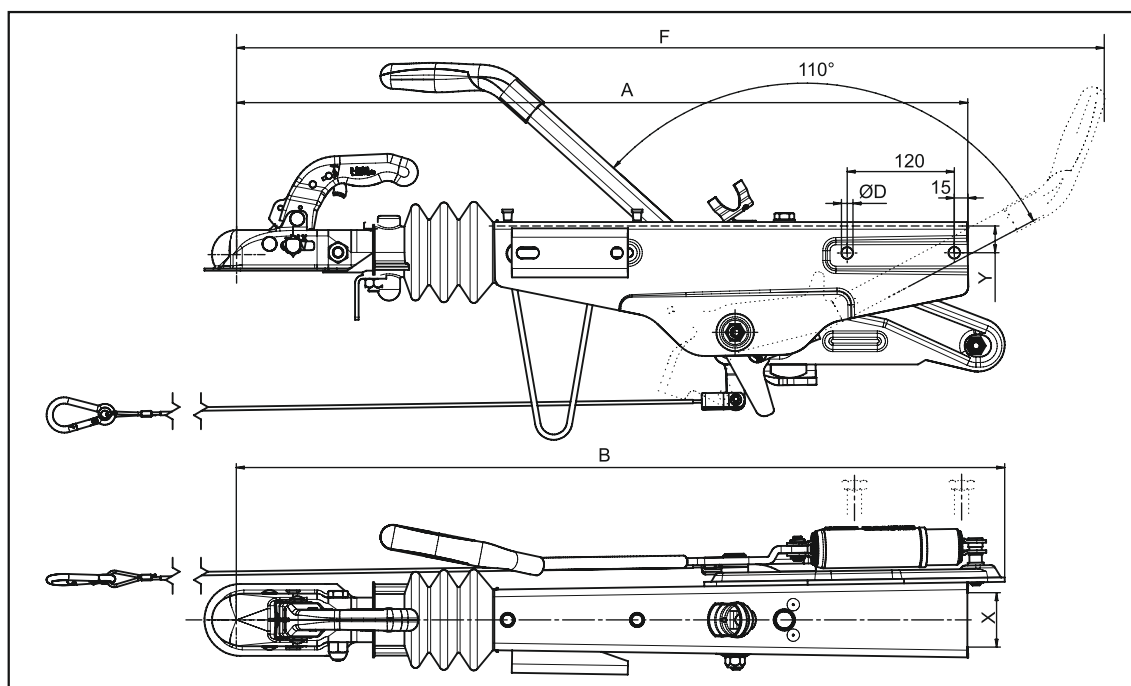
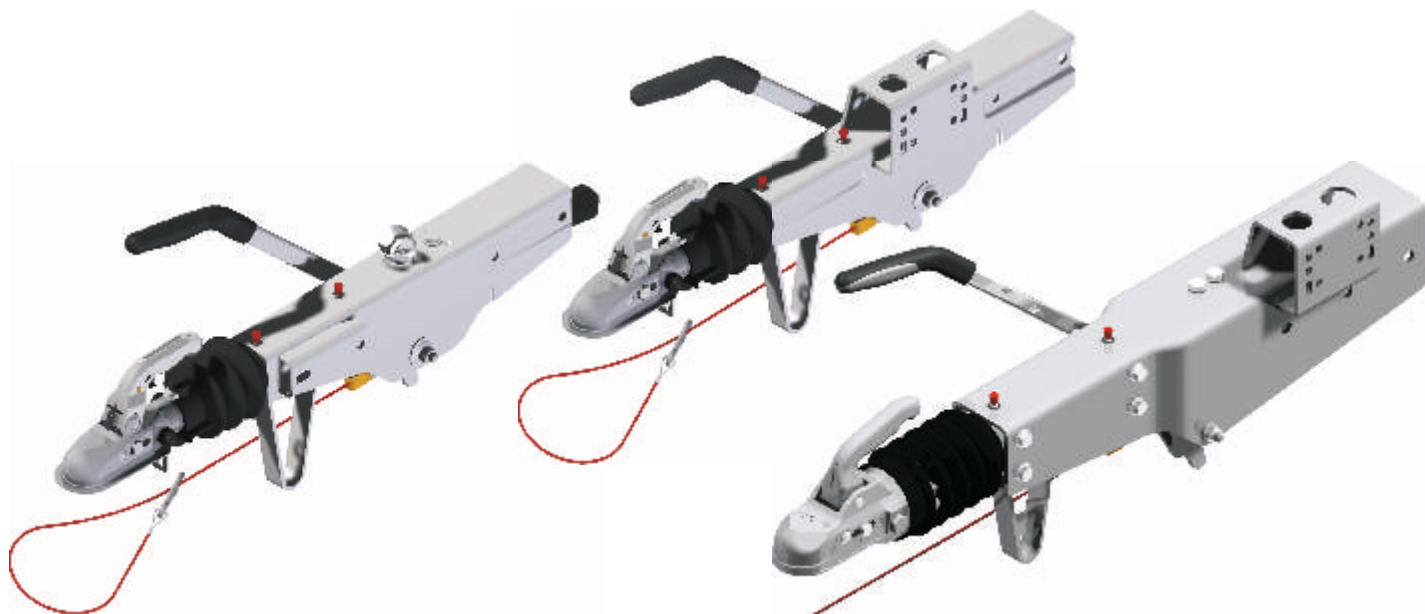

Type	Coupling head	Vertical load (max. kg)	Load capacity (kg)	A (mm)	B (mm)	D (mm)	F (mm)	X (mm)	EC-number	ECE number	Article number
KRV 7,5-C	KK14BN3	75	750	819	649	13	940	60	00-1010	55R-011010	6X0330.007
KRV 13-C	KK14BN3	100	1300	819	861	13	972	60	00-1010	55R-011010	6X0330.001
KRV 17-C	K20BN3	100	1700	819	861	13	972	60	00-1010	55R-011010	6X0330.002
KRV 20-A	K20BN3	100	2000	836	873	16,5	984	100	00-1018	55R-011018	6J1739.101
KRV 30-A	K35AN3	150	3000	853	942	16,5	913	80	00-1052	---	6X0330.030
KRV 35-A	K35CN3	150	3500	988	1010	16,5	1037	120	00-1588	---	203995.001

The overrunning can be ordered either with DIN, or with NATO eye.

There is no trailer without us

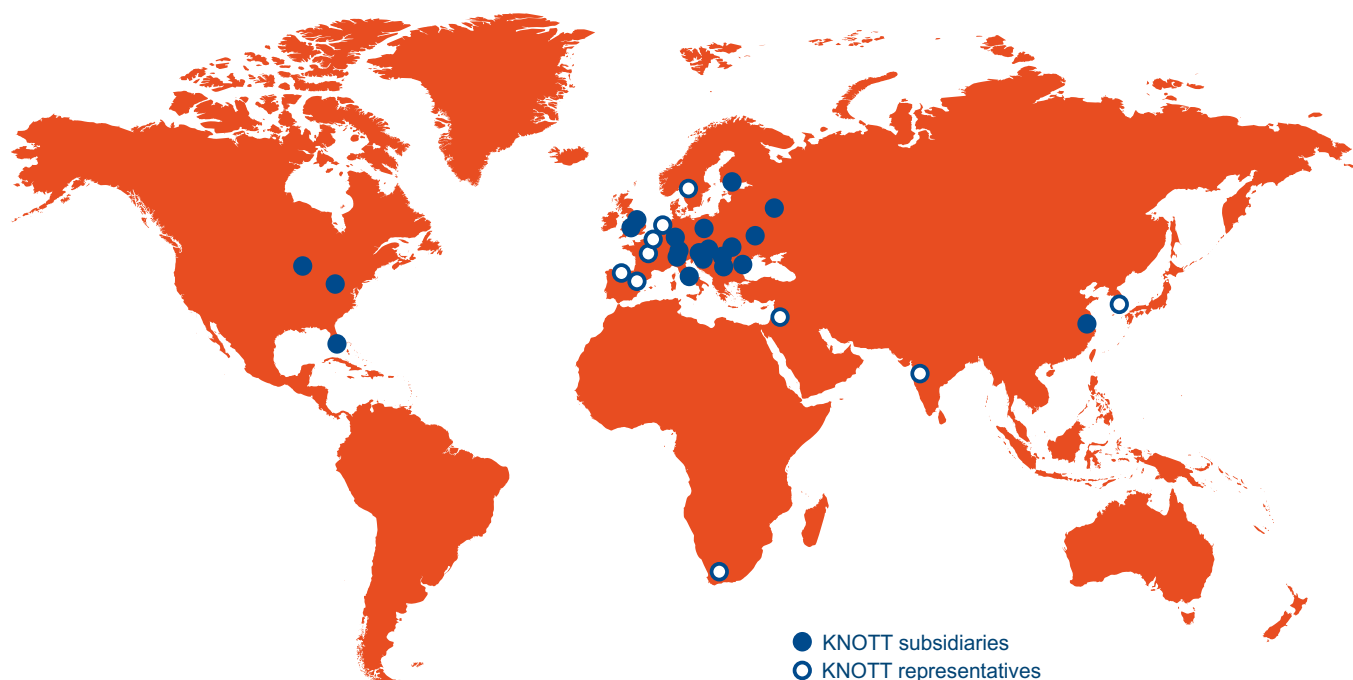

The Knott Group - global competency

The member companies of the Knott Group design, develop, produce and market braking systems for commercial and off-highway vehicles together with running gear components for trailers.

Competent, one-to-one consulting and outstanding product quality are characteristic of all the companies within the Group.

KNOTT's own production plants and branch offices are supported by a world-wide dealership network.



www.autoflex.ro

KNOTT GROUP
BRAKE AND TRAILER TECHNOLOGY

Presented by:

AUTOFLEX SRL

Tel.: (+40) 259/373-495 Fax: (+40) 259/406-748
RO-415500 Salonta - Sos. Aradului km 75+300 - Romania
web: www.autoflex.ro e-mail: info@autoflex.ro